

# Janisol C4 EI60/EI30 Fire doors

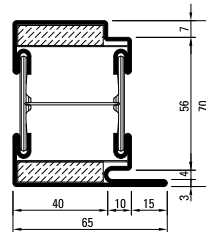

## Janisol C4 EI60 and Janisol 2 EI30: a new combination of reliable fire protection systems

Increased requirements for security within a building mean that the demand for functional interaction between different fire protection requirements is becoming more and more frequent. Depending on the specific national regulation, this affects, for example, stairwells that serve as an escape route in emergencies. So that technically demanding combinations also fulfil aesthetic requirements, individual door profiles from the tried-and-tested Janisol 2 EI30 fire protection system were enhanced through the addition of a basic depth of 70 mm. As a result, transparent Janisol C4 EI60 fire walls – in extreme cases even EI90 fire walls – can now be combined with Janisol 2 EI30 doors with ease. The extended range of steel profiles includes door, transom and sill rail profiles in raw and galvanised finishes. Take account of national approvals.



630.013.5  
630.013.5 Z

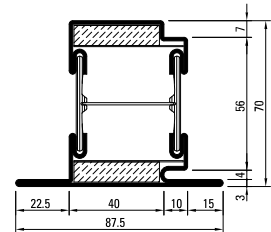

630.114.5  
630.114.5 Z

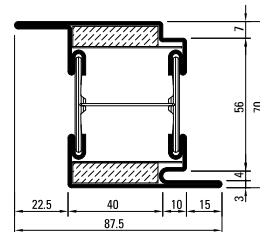

630.416.5  
630.416.5 Z

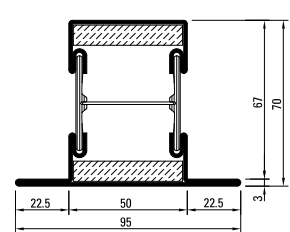

602.685.5  
602.685.5 Z

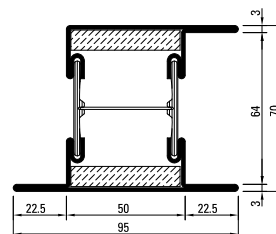

605.685.5  
605.685.5 Z

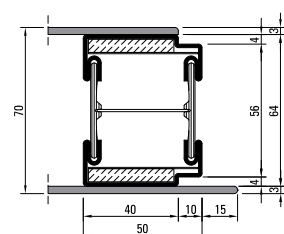

600.010.5 Z

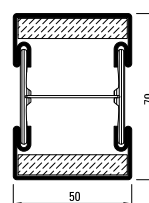

600.005.5  
600.005.5 Z

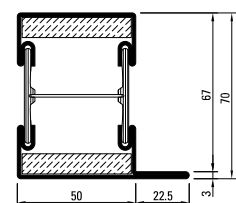

601.685.5  
601.685.5 Z

Example of Janisol C4 EI60/EI30 (70 mm)

